

Product Installation Guidelines & Scope of Use

Version 5, 16 April 2025, Page 1 of 4
Document No.: TC54FJ1C

CliniLever® CP-BS Hospital Wall Bib Tap Type 54 Fixed 150 J/V

PRODUCT CODES:

- TC54FJ1C

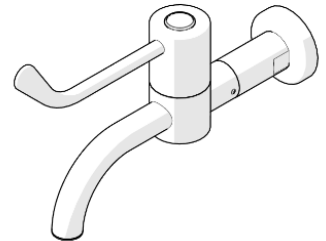

SPECIFICATIONS

- The CliniLever® product range is primarily used for hand washing applications in medical facilities, hospitals, aged care facilities, schools and in-home care.
- CliniLever® products provide state of the art features to comply with the latest healthcare guidelines.
- The single lever for on/off, hot/cold temperature has a straightforward operation which simplifies hand washing.
- All CliniLever® products provide laminar flow (not aerated).
- Our highly sought after lever handle design can easily be operated with wrist or elbows.
- The main body is made of solid dezincification resistant (DR) brass rod, with a DR brass fixed outlet.
- Quick action SBA's includes brass jumper valve component, with red and blue indicator button on 150mm lever action handles.

IMPORTANT: All CliniLever® healthcare taps are tested in accordance with AS 3718 and leave our premises in good working order.

TECHNICAL DATA

| | | |
|--------------------------------|-----------------|-----|
| Inlet | ½" BSP – Female | |
| Outlet | Laminar Flow | |
| Headwork | Jumper Valve | |
| Working Pressure Range (kPa) | Min | 50 |
| | Max | 500 |
| Working Temperature Range (°C) | Min | 5 |
| | Max | 65 |
| Nominal Flow Rate (LPM) | 5.06 | |
| Finish | Chrome | |

NOTE: Galvin Engineering continually strive to improve their products. Specifications may change without notice.

TOOLS REQUIRED

- Spanner and hex key
- Thread tape

PRE-INSTALLATION - MOUNTING DETAILS

Wall Spud

- Wall spuds must be G 1/2" and protrude from the finished wall by no more than 15mm

Note: In some situations, a male thread connection on the tap may be more suited. If so, please contact us on 1300 514 074

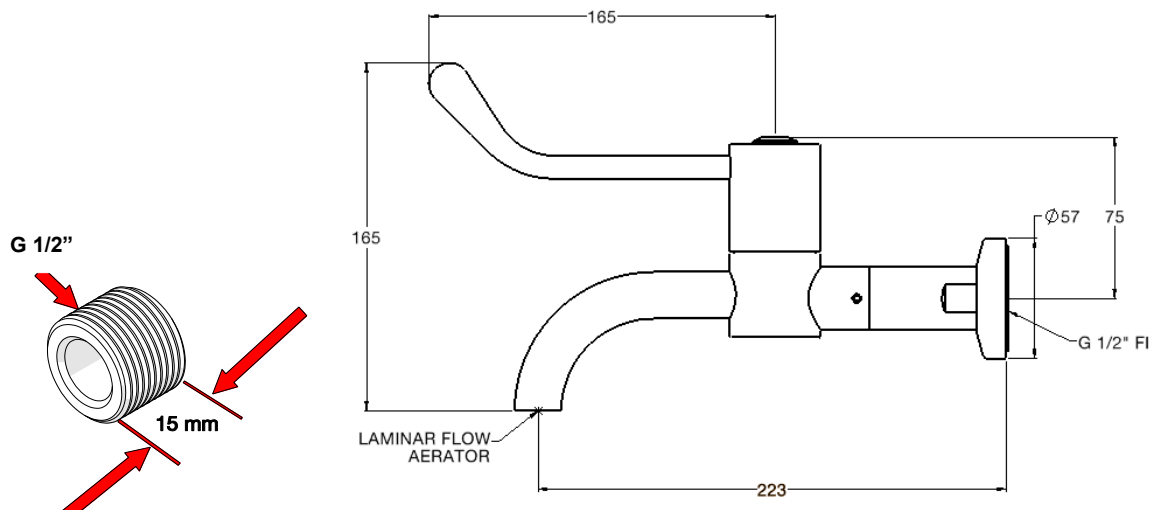

INSTALLATION

IMPORTANT: Galvin Engineering products must be installed in accordance with these installation instructions and in accordance with AS/NZS 3500, the PCA and your local regulatory requirements. Water and/or electrical supply conditions must also comply to the applicable national and/or state standards. Failing to comply with these provisions shall void the product warranty and may affect the performance of the product.

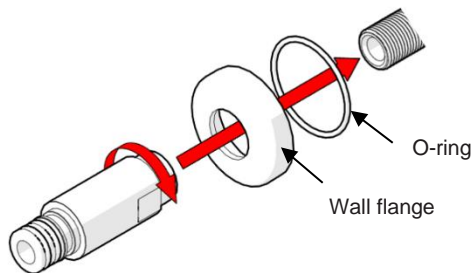

1. Fit wall flange

- Remove the inlet tail from the body and take the wall flange out of the packaging.
- Ensure O-rings are secure in the rear of the wall flange and slide over the inlet tail.

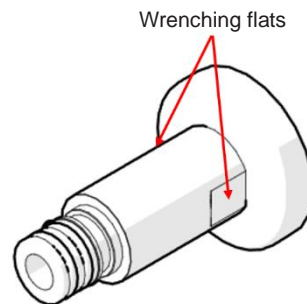

2. Fit inlet tail

- Fit the inlet tail with wall flange to the wall spud and fasten with a 27mm spanner or an adjustable wrench using the wrenching flats. Use thread tape or equivalent to ensure the connection does not leak.

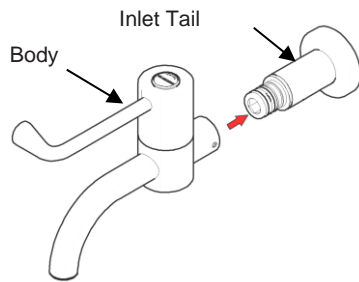

3. Fit body

- Check inlet tail to ensure O-rings are fitted correctly and in good condition to prevent leakage.
- Fit the body onto the inlet tail until it sits flush against it taking care not to damage the O-rings.

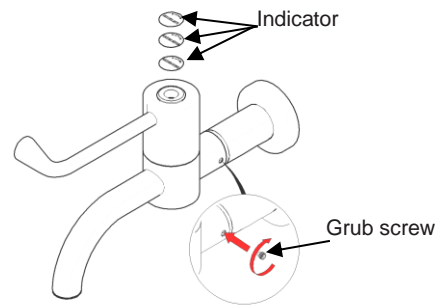

4. Fit grub screws, indicator & testing

- Ensure the body is pushed firmly against the inlet tail and then secure in place with the supplied grub screws. **ENSURE ALL TWO (2) GRUB SCREWS ARE FITTED WITH SUPPLIED ALLEN KEY. If Grub Screws are missing, contact us on 1300 514 074.**
- Once grub screws are secure, fit the water temperature indicator.
- Cold indicator must be blue, hot must be red and warm must be yellow.
- Turn water on. Open the lever handle, inspect the tap and check for any leaks.

TROUBLESHOOTING

| PROBLEM | CAUSE | RECTIFICATION |
|--------------------------------|--|--|
| Taps are dripping water. | Jumper valve is worn or damaged. | Replace jumper valve. |
| | Tap seat is damaged. | Refurbish tap seat using a reseating tool. |
| Water is leaking from spindle. | O-ring on jumper valve spindle is damaged or worn. | Replace o-ring. |
| Water is not flowing from tap. | Water is turned off. | Turn water on. |
| | Aerator or flow regulator is blocked by debris. | Remove aerator and/or flow regulator from tap and remove debris. Install an inline strainer. |
| Spindle is difficult to turn | Build up of scale on spindle, spindle worn or o-ring has been damaged. | Remove jumper valve, clean and regrease. Replace o-ring. Complete SBA may need to be replaced. |
| Handle is loose. | Screw has come loose. | Tighten handle screw. |

SERVICE AND MAINTENANCE

1. Turn off the water supply and turn on the tap handle to drain water from the bodies.
2. Remove the temperature indicator from the handle.
3. Remove the handle from the tap.
4. Unscrew the top assembly from the body.
5. Check the o-ring on the spindle and the jumper valve for wear and damage.
Replace if required.
6. Clean the spindle and body of debris.
7. Place a new o-ring (if required) onto the spindle and re-grease with potable water approved grease.
8. Re-assemble top assembly. Following the product installation guidelines.

WARRANTY

Galvin Engineering products are covered under our Manufacturer's Warranty. Galvin Engineering products must be installed in accordance with the installation instructions and in accordance with AS 3500 and NCC Volume Three, relevant Australian Standards and local authorities applicable to product being installed. Water and electrical supply conditions must also comply to the applicable national and/or state standards, failing to comply with these provisions may void the product warranty and affect performance of the product.

Please visit www.galvinengineering.com.au to view the full warranty, our Installation Compliance and Maintenance & Cleaning information as well as any other additional information.

Within Australia: 1300 514 074 Outside Australia: P: +61 (0)8 9338 2344

F: +61 (0)8 9338 2340

sales@galvinengineering.com.au

www.galvinengineering.com.au

ABN: 78 008 719 382

PERTH | SYDNEY | MELBOURNE | BRISBANE | ADELAIDE

